

THE UNIVERSITY OF MICHIGAN
REGENTS COMMUNICATION

ACTION REQUEST

Approved by the Regents
May 15, 2008

Subject: University of Michigan – Flint
Kearsley Street Extension

Action
Requested: Approval to Proceed with Project

Background:

This project will restore the section of Kearsley Street between Wallenberg Street and Chavez Drive across the south end of the Flint Campus. This extension of Kearsley Street will provide a direct link between the Flint Cultural Center, the University of Michigan – Flint and downtown Flint, with linkages to Mott Community College, the Mott family estate at Applewood, and Kettering University. Reinstating this connection is a vital component of a plan for the redevelopment of the city of Flint and the future growth and prosperity of its educational and cultural partners. The project includes reconstruction of Kearsley Street, including new roadway surface, sidewalks, sewers and utility tunnel work, landscaping, and street lighting. Should resulting roadway vibrations impact research equipment in the William R. Murchie Science Building, the project includes funds for vibration dampening measures. There will be no impact on parking from this project.

The estimated cost of the project is \$1,900,000. Funding will be provided from a Charles Stewart Mott Foundation grant. The construction cash flow may be provided, all or in part, by increasing the commercial paper issuance under the commercial paper program, secured by a pledge of General Revenues, and authorized by the Regents. The engineering firm of Rowe Incorporated will design the project. Construction is scheduled to be completed in Spring 2009.

We recommend that the Regents approve the Kearsley Street Extension project as described, and authorize issuing the project for bids and awarding construction contracts providing that bids are within the approved budget.

Respectfully submitted,

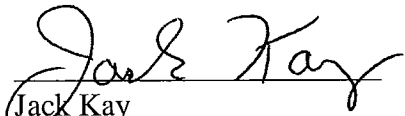
Jack Kay
Interim Chancellor
University of Michigan – Flint

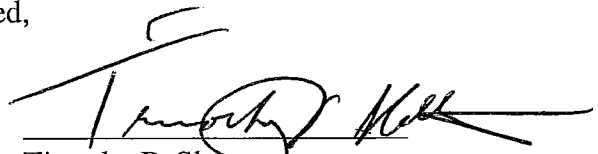
Timothy P. Slottow
Executive Vice President and
Chief Financial Officer

May 2008
Attachment

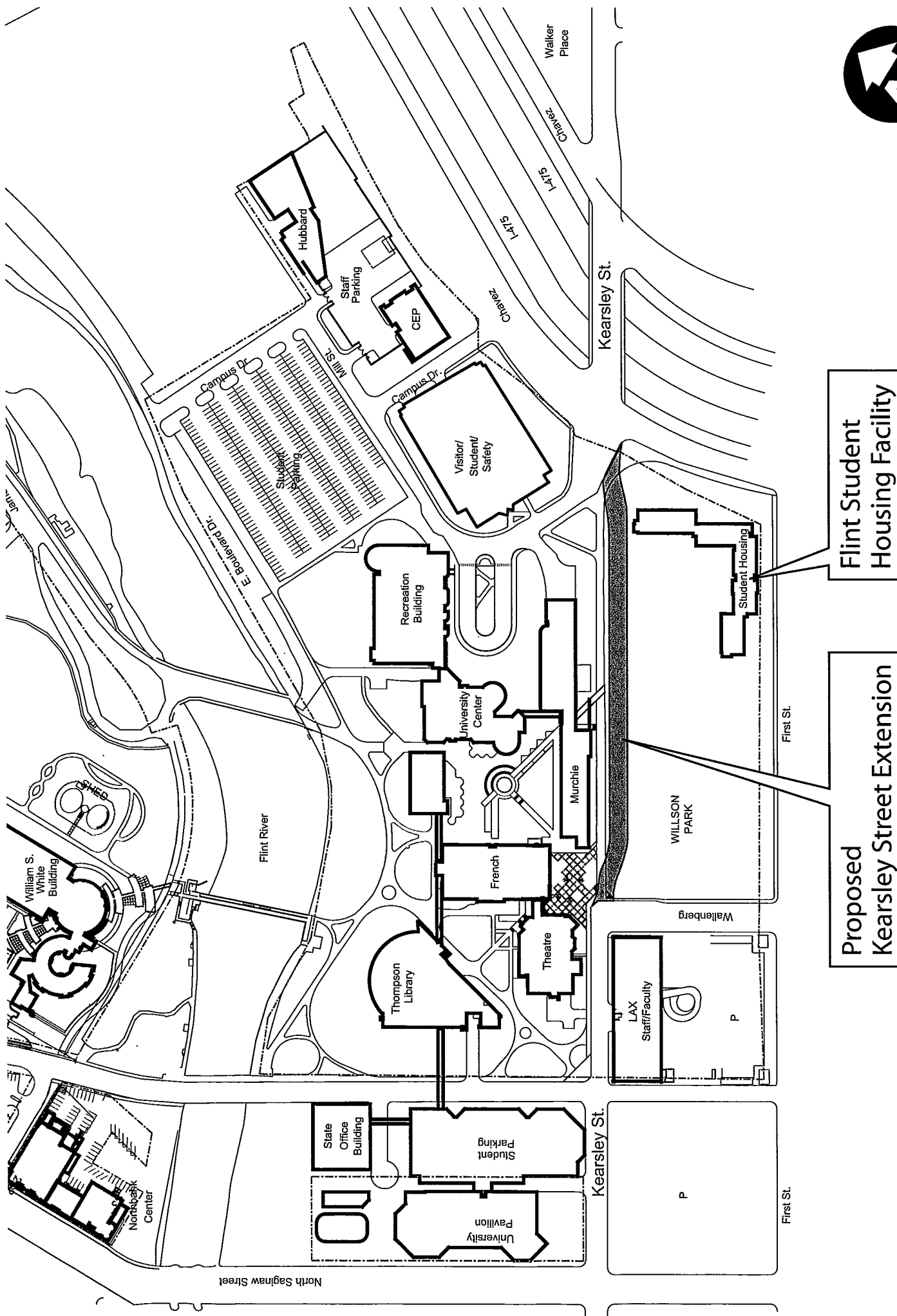

Flint Student Housing Facility

Proposed Kearsley Street Extension



Scale: 0 50' 100' 150' 200'
 University of Michigan
 AEC/UPO | 5.2.08

U-M FLINT KEARSLEY STREET EXTENSION MAP