

THE UNIVERSITY OF MICHIGAN
REGENTS COMMUNICATION

ACTION REQUEST

Approved by the Regents

July 21, 2006

Subject: University of Michigan Hospitals and Health Centers
University Hospital
Front Entrance Traffic Flow Improvements

Action

Requested: Approval to Proceed with Project

Background:

The front entrance to the University Hospital and Taubman Health Center has become extremely congested and difficult for patients and visitors to access due to increased patient activity and demand for valet parking services. Traffic congestion is expected to increase further with the planned closing of the Maternal and Child Health Center entrance in December 2006, coinciding with the initial construction of the C.S. Mott Children's & Women's Replacement Hospital project. This project will reconfigure the main entrance loop, increasing the traffic lanes from three to five to minimize vehicle congestion and improve patient pick-up and drop-off efficiency and valet service. In addition, the project will enhance safety by providing pedestrian islands for crossing East Medical Center Drive, crosswalks within the main entrance zone, and an accessible area serving individuals with disabilities. There will be no impact on parking from this project.

The estimated cost of the project is \$850,000. Funding will be provided from Hospitals and Health Centers' resources. The construction cash flow may be provided, all or in part, by increasing the commercial paper issuance under the commercial paper program, secured by a pledge of General Revenues, and authorized by the Regents. The engineering firm of URS Corporation will design the project. Construction is scheduled to be completed in Fall 2006.

We recommend that the Regents approve the University of Michigan Hospitals and Health Centers University Hospital Front Entrance Traffic Flow Improvements project as described, authorize commissioning the engineering firm of URS Corporation for its design, and authorize issuing the project for bids and awarding construction contracts providing that bids are within the approved budget.

Respectfully submitted,

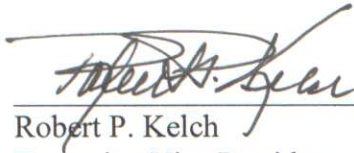

Robert P. Kelch
Executive Vice President
for Medical Affairs

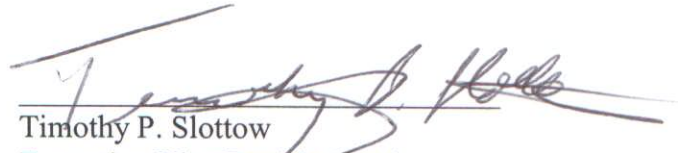

Timothy P. Slottow
Executive Vice President and
Chief Financial Officer

July 2006

Attachment

Taubman Entrance Proposed Site Plan

University of Michigan Health System
July 10, 2006

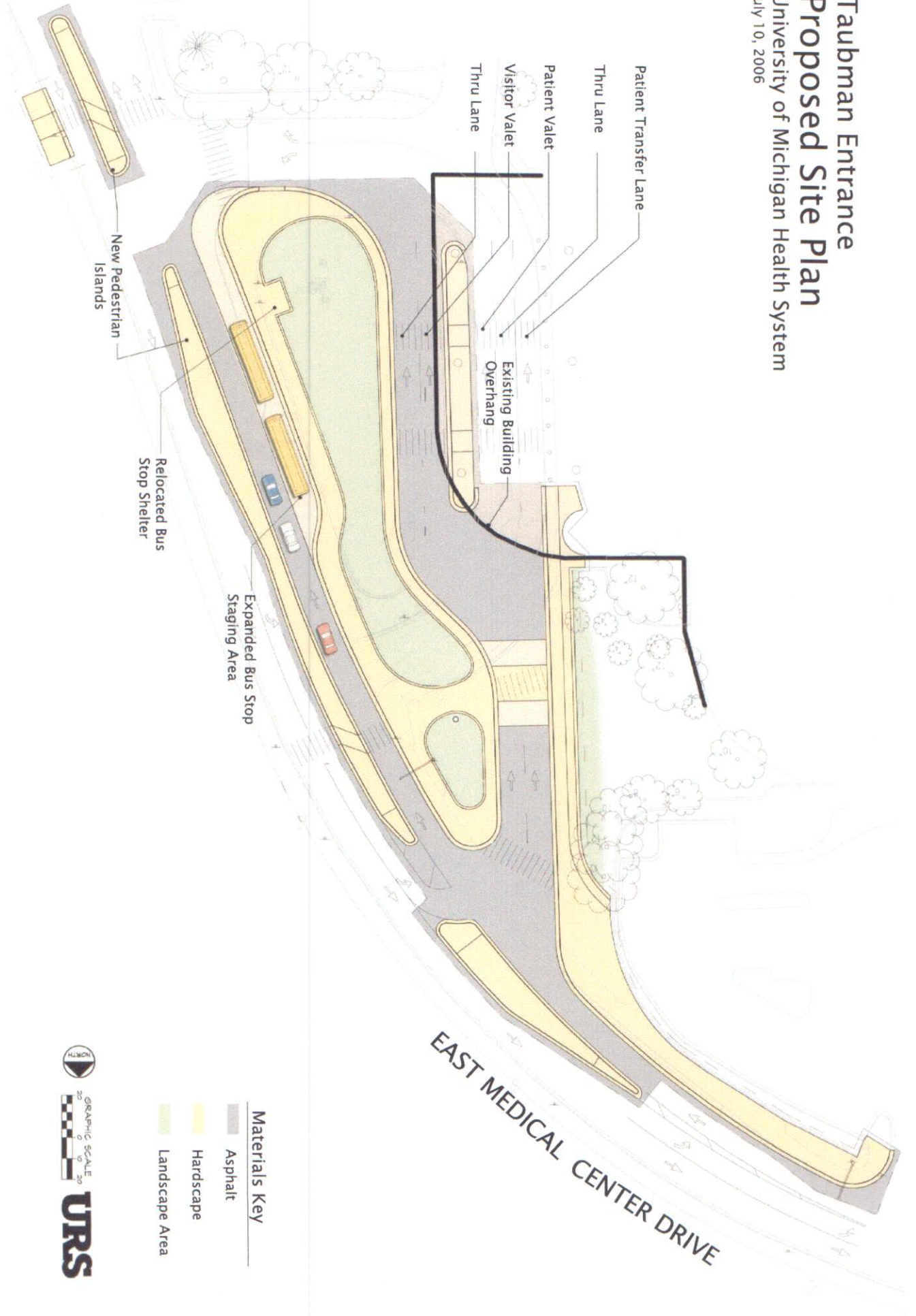

- Materials Key**
- Asphalt
 - Hardscape
 - Landscape Area

GRAPHIC SCALE
URRS